

## Container House

# Catalogue

- ◆ **X Foldable Container House (NECH-XF-20)** .....Rapid deployment, very low cost, easy to transport and unlimited scalability  
For Offices, factories, dormitories, post disaster reconstruction, refugee resettlement
- ◆ **Z Foldable Container House (NECH-ZF-20)** .....Rapid deployment, low cost, easy to transport and unlimited scalability  
For Offices, factories, dormitories, post disaster reconstruction, refugee resettlement
- ◆ **Fast Assembly Container House (NECH-FA-20)** .....Rapid deployment, low cost, unlimited scalability  
For Offices, factories, dormitories, post disaster reconstruction, refugee resettlement
- ◆ **Classic Assembly Container House (NECH-CA-20)** .....easy to transport, low cost, unlimited scalability  
For Offices, factories, dormitories, post disaster reconstruction, refugee resettlement
- ◆ **20FT Dual Wing Expandable Container House (NECH-DW-20)** .....For Residential, hotels, work studios, dormitories  
Rapid deployment, nice size, nice outlook, easy to transfer
- ◆ **40FT Dual Wing Expandable Container House (NECH-DW-40)** .....For Residential, hotels, work studios, dormitories  
Rapid deployment, huge size, nice outlook, easy to transfer
- ◆ **Small Dual Wing Expandable Container House (NECH-DW-20s)** .....or Residential, hotels, work studios, dormitories  
Rapid deployment, nice size, nice outlook, easy to transfer

# X Foldable Container House

Rapid deployment, very low cost, easy to transport and unlimited scalability  
 For Offices, factories, dormitories, post disaster reconstruction, refugee resettlement



Dimensions (14.38m <sup>2</sup> )	14.38m <sup>2</sup> (5800mm*2480mm)-standard
	18m <sup>2</sup> (6000mm*3000mm)-customized
	21m <sup>2</sup> (7000mm*3000mm)-customized
Composition parts	Frame, top,bottom,wall board,door,windows, electrical System
Materials description	The frame structure ,wall board and top: Galvanized Steel
	Thermal insulation layer of top and wall board: glass wool/rock wool
	One steel door and two plastic steel windows, fireproof glass magnesium floor
Gross weight	1000KG
Remark	Internal partitions can be added to separate rooms One 40'HC can hold 12 sets for standard dimension.

# X Foldable Container House

Rapid deployment, very low cost, easy to transport and unlimited scalability  
For Offices, factories, dormitories, post disaster reconstruction, refugee resettlement

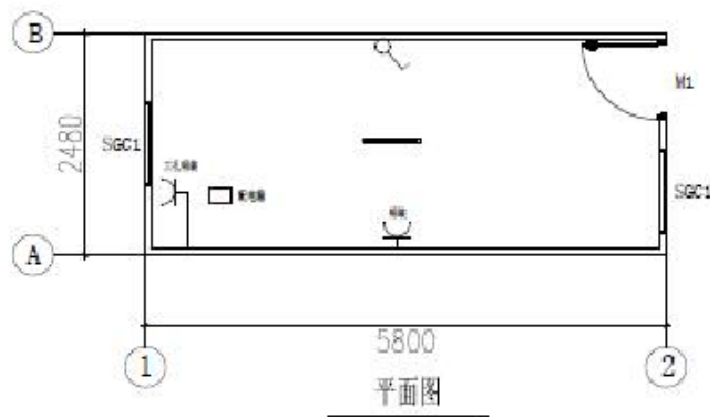
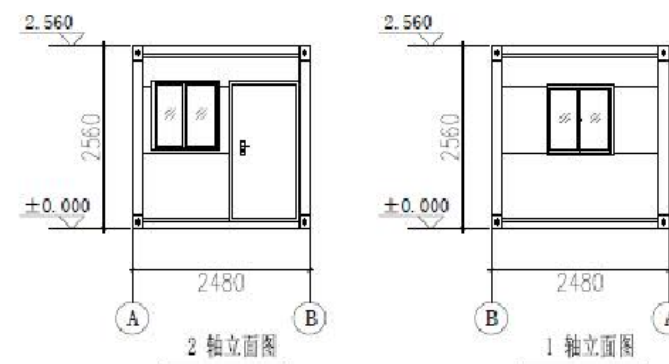
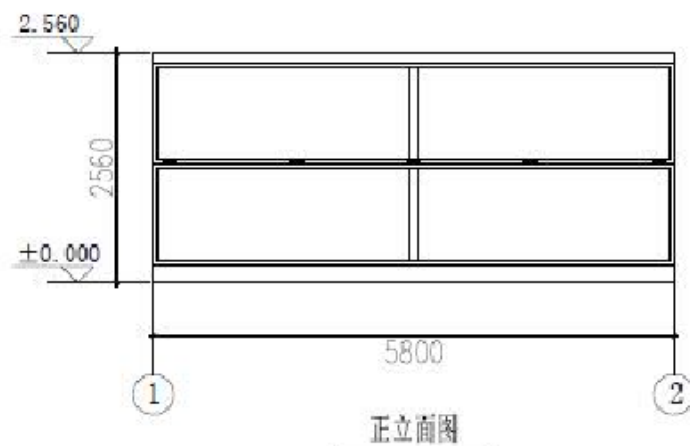

# Z Foldable Container House

Rapid deployment, low cost, easy to transport and unlimited scalability

For Offices, factories, dormitories, post disaster reconstruction, refugee resettlement



Dimensions (14.5m2)	14.5m2 (5800*2500mm)-standard
	18m2(6000mm*3000mm)-customized
	21m2(7000mm*3000mm)-customized
Composition parts	Frame, top,bottom,wall board,door,windows, electrical System, drainage system
Materials description	The frame structure ,wall board and top: Galvanized Steel. Structure surface: electrostatically sprayed white
	Thermal insulation layer of top and wall board: glass wool/ rock wool
	One steel door and two plastic steel windows, fireproof glass magnesium floor, PVC plastic floor. Structure and surface: electrostatically sprayed white
Gross weight	1400KG
Remark	Internal partitions can be added to separate rooms One 40'HC can hold 6 sets for standard dimension.

# Fast Assembly Container House

Rapid deployment, low cost, unlimited scalability

For Offices, factories, dormitories, post disaster reconstruction, refugee resettlement



Dimensions (13.92m2)	13.92m2 (5800mm*2400mm)-standard
	18m2(6000mm*3000mm)-customized
	21m2(7000mm*3000mm)-customized
Composition parts	Frame, top,bottom,wall board,door,windows, electrical System, drainage system
Materials description	The frame structure ,wall board and top: Galvanized Steel
	Thermal insulation layer of top and wall board: glass wool/rock wool
	One steel door and two plastic steel windows, fireproof cement fiber board floor,
Gross weight	1400KG
Remark	Internal partitions can be added to separate rooms One 40'HC can hold 10 sets for standard dimension.

# Fast Assembly Container House

Rapid deployment, low cost, unlimited scalability

For Offices, factories, dormitories, post disaster reconstruction, refugee resettlement



# Classic Assembly Container House

Easy to transfer, low cost, unlimited scalability

For Offices, factories, dormitories, post disaster reconstruction, refugee resettlement



Dimensions (18m2)	18m2(6000mm*3000mm)-standard
	21m2(7000mm*3000mm)-customized
Composition parts	Frame, top,bottom,wall board,door,windows, electrical System, drainage system
Materials description	The frame structure ,wall board and top: Galvanized Steel
	Thermal insulation layer of top and wall board: glass wool/rock wool
	One steel door and two plastic steel windows, fireproof cement fiber board floor, drainage system, electrical System
Gross weight	1200KG
Remark	Internal partitions can be added to separate rooms One 40'HC can hold 14 sets for standard dimension.

# Classic Assembly Container House

Easy to transfer, low cost, unlimited scalability

For Offices, factories, dormitories, post disaster reconstruction, refugee resettlement





# 20FT Dual Wing Expandable Container House

Rapid deployment, nice size, nice outlook, easy to transfer  
 For Residential, hotels, work studios, dormitories



Dimensions (37.3m <sup>2</sup> )	Unfolded size : 5900mm(L) * 6300mm(W) * 2480mm(H)
	Folded size: 5900mm(L) * 2200mm(W) * 2480mm(H)
Composition parts	Frame, top,bottom,wall board,door,windows, electrical System
Materials description	The frame structure ,wall board and top: Galvanized Steel
	Thermal insulation layer of top and wall board: EPS
	One steel door and four plastic steel windows, fireproof glass magnesium floor and bamboo glue floor, electrical System
Gross weight	2600KG
Remark	The external color and internal layout can be customized One 40'HC can hold 2 sets for standard dimension.

# 20FT Dual Wing Expandable Container House

Rapid deployment, good area, nice outlook, easy to transfer  
For Residential, hotels, work studios, dormitories

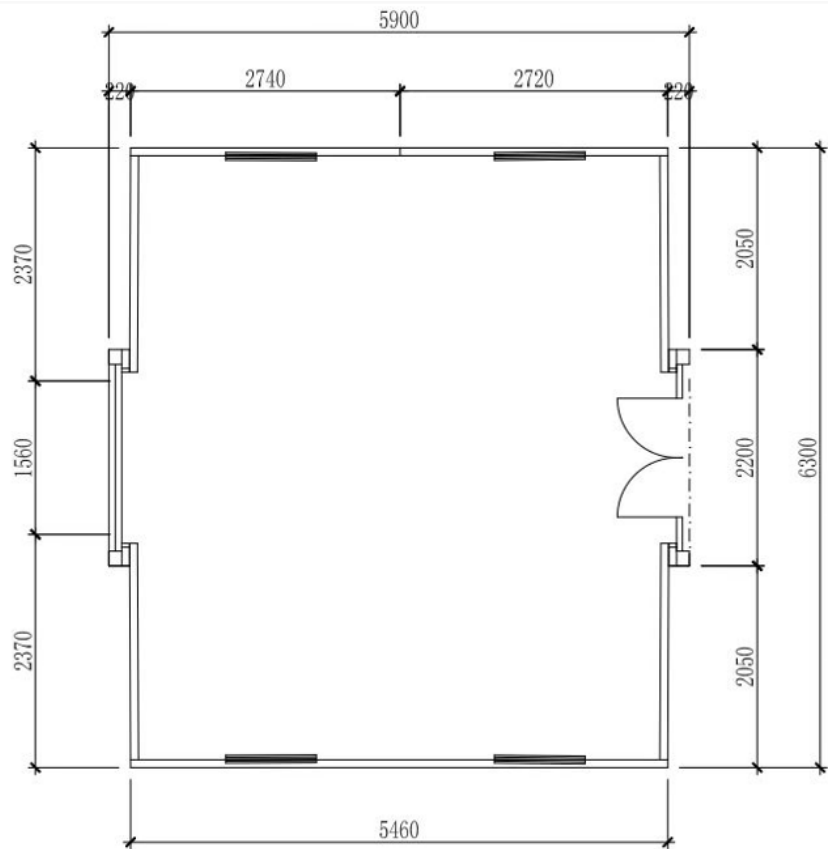

# 20FT Dual Wing Expandable Container House

Rapid deployment, good area, nice outlook, easy to transfer  
For Residential, hotels, work studios, dormitories



# 20FT Dual Wing Expandable Container House

Rapid deployment, good area, nice outlook, easy to transfer  
For Residential, hotels, work studios, dormitories

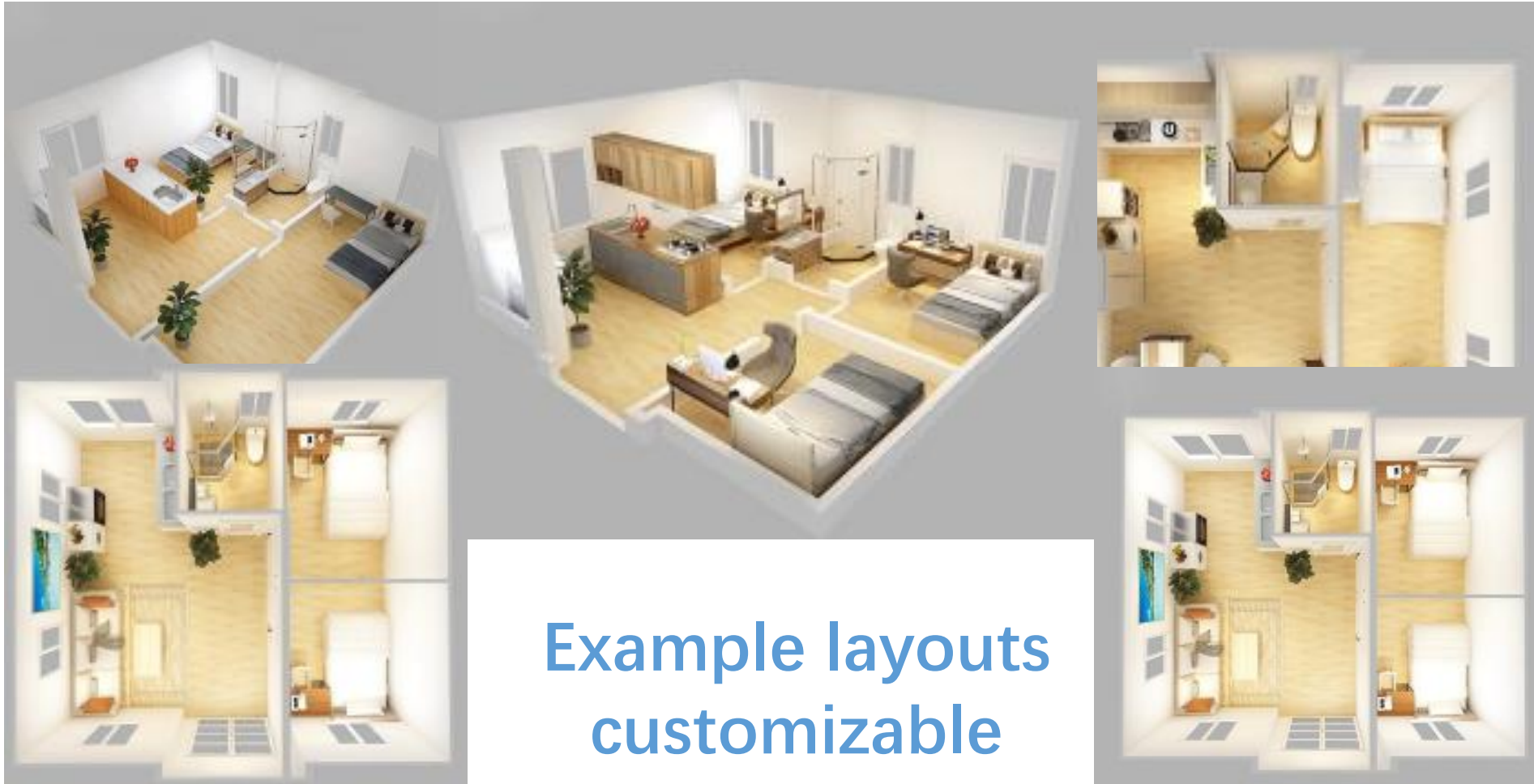

# 40FT Dual Wing Expandable Container House

Rapid deployment, huge area, nice outlook, easy to transfer  
 For Residential, hotels, big offices, work studios, dormitories



Dimensions (73m <sup>2</sup> )	Unfolded size : 11800mm(L) * 6200mm(W) * 2480mm(H)
	Folded size: 11800mm(L) * 2200mm(W) * 2480mm(H)
Composition parts	Frame, top,bottom,wall board,door,windows, electrical System
Materials description	The frame structure ,wall board and top: Galvanized Steel
	Thermal insulation layer of top and wall board: EPS
	One steel door and 8 plastic steel windows, fireproof glass magnesium floor and bamboo glue floor, electrical System
Gross weight	4600KG
Remark	The external color and internal layout can be customized One 40'HC can hold 2 sets for standard dimension.

# 40FT Dual Wing Expandable Container House

Rapid deployment, huge area, nice outlook, easy to transfer  
For Residential, hotels, big offices, work studios, dormitories

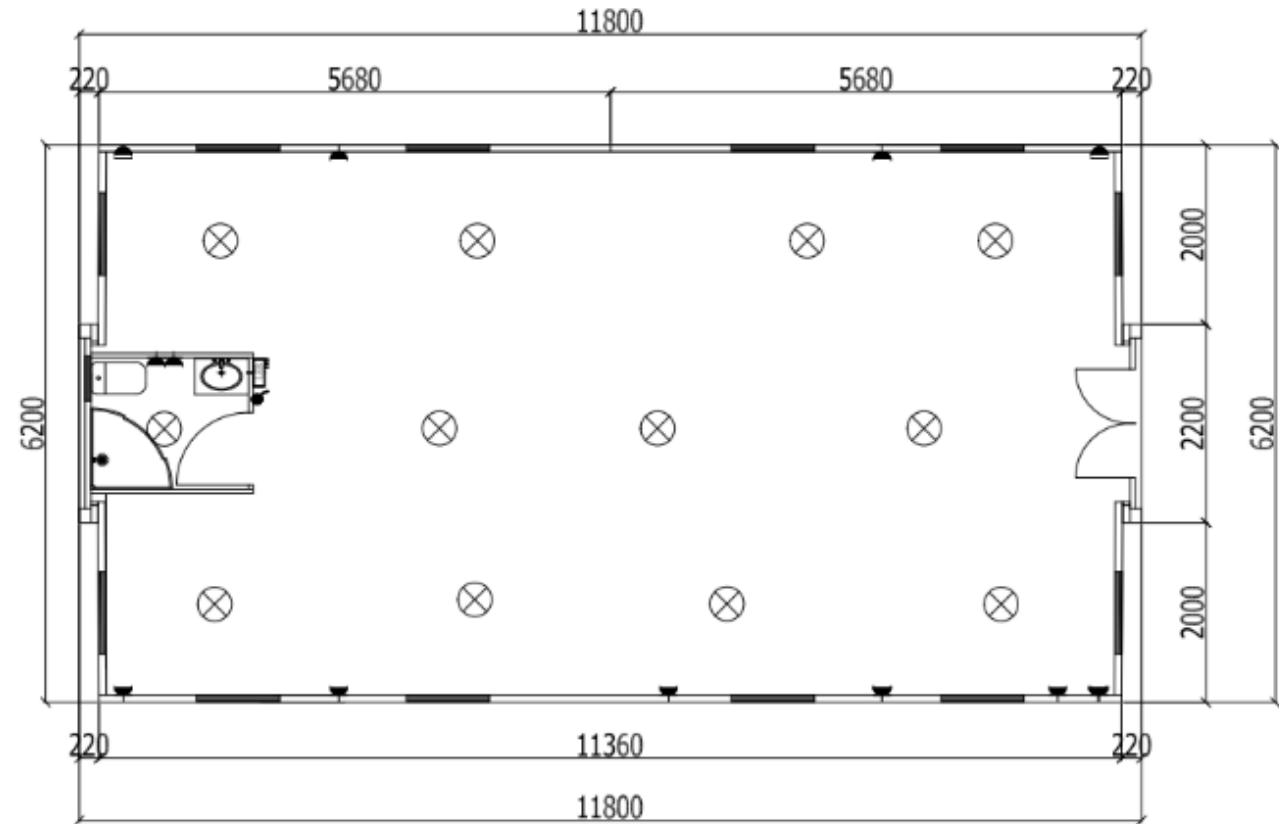

# 40FT Dual Wing Expandable Container House

Rapid deployment, huge area, nice outlook, easy to transfer  
For Residential, hotels, big offices, work studios, dormitories

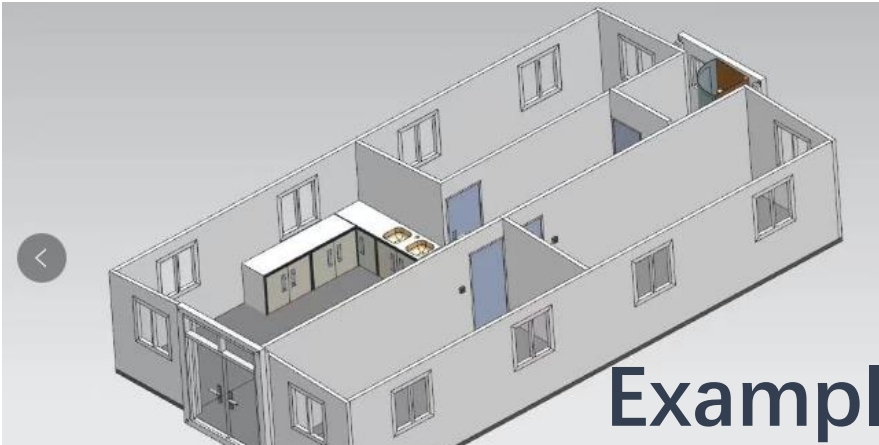

**Example layouts  
customizable**



# Small Dual Wing Expandable Container House

Rapid deployment, low freight, nice outlook, easy to transfer  
 For Residential, hotels, offices, work studios, dormitories



Dimensions (27.9m <sup>2</sup> )	Folded size : 5850mm(L) * 560mm(W) * 2500mm(H)
	Unfolded size: 5850mm(L) * 4760mm(W) * 2500mm(H)
Composition parts	Frame, top,bottom,wall board,door,windows, electrical System
Materials description	The frame structure ,wall board and top: Galvanized Steel
	Thermal insulation layer of top and wall board: EPS
	One steel door and 4 plastic steel windows, plywood floor board, electrical System
Gross weight	1800KG
Remark	The external color and internal layout can be customized One 40'HC can hold 8 sets for standard dimension.



# Thank you for your attention!

Selena.Yuan  
Sales manager

[szneweasy@gmail.com](mailto:szneweasy@gmail.com)

[selena.yuan@szneweasy.cn](mailto:selena.yuan@szneweasy.cn)

Cellphone/WhatsApp +8613342912351

SZ NEW EASY LTD.

No.1, Huanguan South Road, Guanlan Dist, Shenzhen, China